

Operation and installation instruction



Please read this instruction carefully before use and keep it properly.

Catalogue

Warranty notes	3
Product feature	4
Instructions for use	5
Add cleaning enzyme	8
Brightener	9
The water softener	10
Set up cleaning program	12
Notes after cleaning	13
Error code.....	14
Installation instructions	15
The size for machine and cabinet	16

After-sales attention:

If there is any abnormal phenomenon in the use of your product, please stop using it immediately, unplug the power cord and contact our after-sales service team in time. If the user carries out the maintenance by himself or by employing the maintenance personnel who are not specially appointed by the factory, all the consequences caused thereby shall be borne by the user himself.

Warranty provisions:

1. The whole machine is guaranteed for 1 year from the date of purchase.
2. When enjoying the product warranty service, the user must hold the relevant three guarantees certificate of the product to be repaired (the product warranty card provided by the company along with the machine), and the three guarantees validity period will be calculated according to the factory date.
3. Term of use: 5 years

Warranty Notes:

The following conditions do not fall within the scope of warranty, and maintenance services at a fee will be provided:

1. The damage is caused by force majeure;
2. Products exceeding the specified warranty period;
3. Failed to provide the warranty certificate;
4. The company has indicated that it does not offer free warranty products;
5. The user installs, disassembles and repairs by himself or by hiring maintenance personnel not specially appointed by the factory;
6. The warranty certificate does not conform to the product or has been altered.
7. Damage caused by improper handling, use, installation, maintenance and storage by consumers;
8. All losses and damages caused by factors beyond our control, such as power supply, water source, temperature and humidity, etc ;

Product feature

Advocate energy conservation and environmental protection, enjoy comfortable life



Multiple washing programs meet different needs



Triple filter, Improve water efficiency



Efficient aseptic program make sure



Anti-creeping
Prevent overflow
Malfunction alarm



Energy saving wash save water and save money



Clean the filter regularly



Avoid direct sunlight



Glass panel
Easy to cleaning



Please cut off the power if not Used for a long time



Please choose the Special soft water salt

Range of application

Used for cleaning before sterilizing and sterilizing medical instruments, without sterilizing function.

Instructions for use

This section records the important contents of safety matters to prevent personal injury or property loss to users and others. Please read the text based on full understanding of the content below (logo, icon), and be sure to follow the safety instructions recorded.



safety warning

This sign indicates that operation error may seriously damage the cleaning machine or cause death or injury to the user or cause electrical hazard or fire hazard.



It must be installed or removed by professionals. It is forbidden to dismantle, modify or repair without authorization. Installation without authorization may lead to electric shock, fire, water leakage, such as not installing the air switch with protection device, leakage protection switch or installation is incorrect, may lead to electric shock.

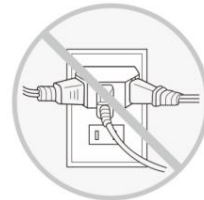

It is forbidden to replace the power cord without authorization, or connect the power cord or use it in parallel with other electrical appliances without authorization, connect the power cord halfway, or use overload, which may lead to electric shock or cause fire. If the power cord is damaged, please entrust the local dealer or service network to repair it.

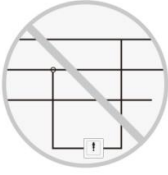

The washer must be grounded. In case of failure or damage, the ground wire can divert almost all the current due to its low resistance, thus effectively protecting you from electric shock.



Please cut off the power When abnormal phenomena (such as burnt smell) occur.



During thunderstorm, the power supply must be disconnected. If the power is continuously turned



Do not use wet hand plug plug, with wet hand plug power supply will be shocked.



Please do not over-bend or extrude the power cord in case of electric shock or fire. If the power cord is damaged, it must be replaced by a professional.



Unplug and turn off the faucet when repairing, cleaning or not in use for a long time



Pay attention to the steam and water when opening the door. If you need to open the door in the process of operation, please press the "pause" button to stop washing, open the small gap, wait for a while to open the door.



When opening the door, please pay attention to the steam and do not let the child play with the cleaning machine. When the door is open, please keep the child away from the cleaning machine.



Do not use the cleaning machine before installation. Please use it after installation and safety inspection.



Please choose the special cleaning machine salt, can not be replaced by edible salt. Non-cleaning machine salt will guide

Add cleaning enzyme

Function of cleaning enzyme: it is necessary to add appropriate amount of cleaning enzyme to assist cleaning when cleaning tools with cleaning machine. Cleaning enzyme can use its biological enzyme to remove oil and block dirt on the tool and take it out of the cleaning machine through drainage.

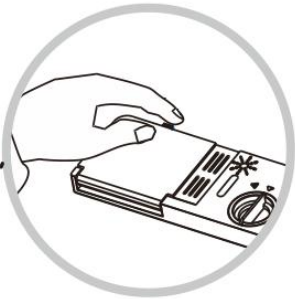

Press the allocator button

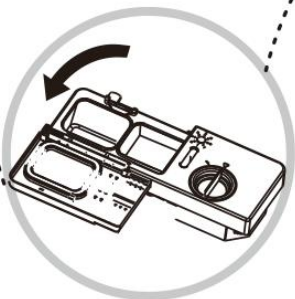

The cleaning enzyme box opens automatically

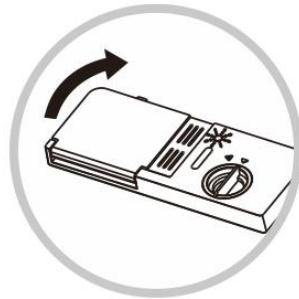

Cover the lid

Brightener action and addition method

Brightener can reduce the surface tension of water, avoid leaving water traces on the tool after washing, and can make the water evaporate evenly and rapidly in the drying process. When you need to add bleaching agent, the lamp on screen will be lit up, please add bleaching agent in time. You can directly observe the amount of bleaching agent left next to the lid and judge the amount of bleaching agent left according to its color change

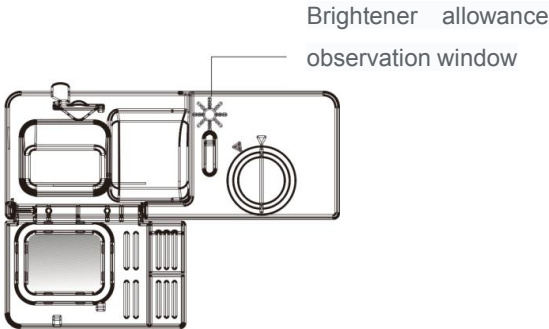

If the drying effect is not ideal or there is stain residue, you can rotate the adjustment knob to adjust the amount of brightener. If there are white and attachments on the applicator, the amount of brightener should be reduced. The factory default value is 4.

Brightener adjusting knob

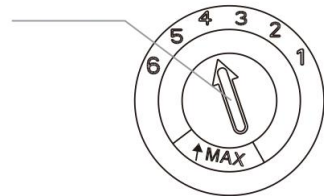

Attention

please use special brightener for cleaning machine.

The water softener

Water softener can soften water quality, reduce scale generation, to improve the cleaning has a certain role, if you are in the area of tap water quality is hard, we suggest you to add salt to the water softener washing machine. Only salt in a water softener can soften it. If the local tap water quality is soft, you can not add salt, do not affect the normal use of the washing machine.

Electronic water softener gear setting:

can adjust salt consumption according to water hardness optimization.



Start Hold down the pause button for 5 seconds, then will enter Settings mode.

Water hardness will show on screen, Factory default is H4

Press the pause button to choose the right water-hardness, then press the delay button will complete the setting and automatically exit the setting state

PPM	Hardness
0-90	H1
100-200	H2
210-300	H3
310-400	H4
410-600	H5
610-800	H6

Lack of salt instructions

When salt is needed, the display light will be on. Please add salt for cleaning machine in time.

Method of adding salt to water:



1 Open the cap of the soft water



2 Insert salt bucket, add 500 grams of special salt for cleaning machine



3 After adding salt, fill the water softener with water, do not overflow



4 Tighten the cap clockwise to prevent salt leakage and corrosion of the liner



5 If salt is sprinkled on the inner tank, please wipe it clean with a cloth, and then run the cleaning procedure for a short time, so as to prevent the leakage of salt water corroding the inner tank, filter screen, motor, and so on, causing damage to the dishwasher.

Setup and operation for cleaning

Make sure the instruments can stand the highest temperature of the corresponding program. Each procedure decontamination ability from strong to weak order is as follows : Power Wash→ Standard Wash→energy-saving Wash→Quick Wash→ Anti-bacterial wash

Program details

Program	Power wash	Standard wash	Energy-saving wash	Quick wash	Anti-bacterial wash
Max washing temperature	70°	68°	68°	65°	73°
Max temperature	4/20g	4/20g	4/20g	10g	0
Brightener	need	need	need	need	no need
Running time (min)	132	98	168	36	46
Energy consumption (kw.h)	1	0.8	0.7	0.65	0.6
Water consumption (L)	12.2	9.8	8.5	7.4	4.7

Attention:



1. Do not add cleaning enzymes when choosing to remove bacteria
2. In the running state, press the pause button to stop the machine if it needs to shut down or change the program .

Introduction of control panel



Start the cleaning program

1. Lay out the tools and close the door
2. Press the power key to enter standby mode , default mode standard wash.
3. Press program key to select mode.
4. Press Start / Pause to start the cleaning.
5. The time display icon flashing represents the start of the cleaning machine.

Notes after cleaning

1. When the cleaning process is finished, the cleaning machine's buzzer will beep for 8 seconds and then go into standby mode,The digital screen display "End",No operation within 30 minutes, automatic shutdown.
2. When the cleaning is finished, the tools are hot ((60~70℃), Allow to cool for 30 minutes before removing.
3. After the cleaning procedure, the door of the cleaning machine can be opened slightly to accelerate the cooling of the tool, which is conducive to the drying of the tool.

Maintenance:

- * In order to maintain good performance and washing effect, please clean regularly.
- *Please make sure the power is disconnected before maintenance.

Error code

When cleaning machine failure, the screen will display the corresponding code as follow:

Error code	Error description	Solution
E1	Water inlet failure	Please call the professional maintenance
E3	Cannot heat	Please call the professional maintenance
E4	Water overflowed	Turn off the tap and call the professional maintenance
E5	Over temperature	Please call the professional maintenance
Ec	System failure	Please call the professional maintenance
E6	Sensor failure	Please call the professional maintenance

Technical specification

Size	596mm*620mm*524mm
Water consumption	8.5L
energy consumption	0.70Kw.h
Net Weight	30KG
Enter water pressure	0.04~1.00MPa
Control mode	Micro computer
Rated voltage	220V
Frequency	50Hz
Rated power	1380W
Waterproofing grade	IPX1
Volume	103L

Installation instructions:

This section contains important information about safety matters, To prevent the user and others to cause personal injury or property damage. Please read the text with a full understanding of the following content (logos, ICONS), Be sure to follow the safety instructions.

The power cannot be connected during installation.

Please check the items in the packing box according to the packing list.

Packing List			
1. Cleaning machine	1 pcs	5. Salt bucket	1 pcs
2. Tool basket	1 pcs	6. Operation manual	1 pcs
3. Handpiece holder	1 pcs	7. Mounting screw	2 pcs
4. Inlet water pipe	1 pcs		

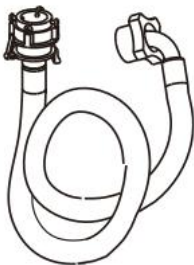

Inlet water pipe



Mounting screw

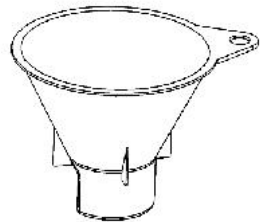

Salt bucket

The size for machine and cabinet:

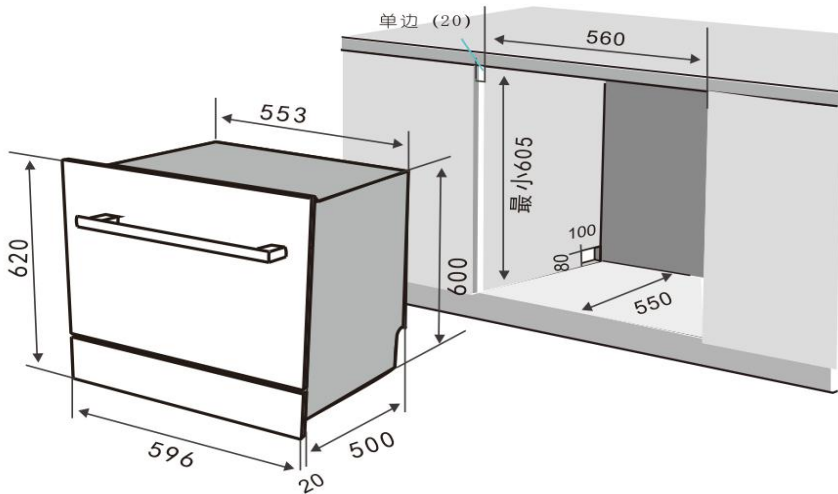

The following inspection must be done before starting the cleaning machine:

1. Put the cleaning machine in a horizontal position and fixed .
2. Turn on the tap.
3. There is no leakage in the water pipe connection.
4. Connect the wire .
5. Power on or off .
6. Whether the inlet and drain pipes are twisted and knotted .
7. All the materials and product should be taken out from cleaning machine .



Check the water inlet
for leaks

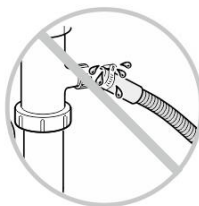

Check the water outlet
for leaks

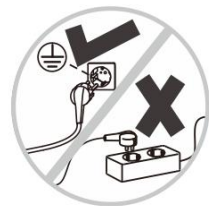

Mobile sockets are not
recommended

※ In line with the purpose of continuous improvement and renewal of products, The manufacturer can make certain modifications to the product without notice.